

# Linear Rotary Axis (ZU40)

## Overview

The ZU40 is a compact high precision actuator for linear and rotary motion. Designed to be combined with the HG60 gantry to give full 4 axis motion.

The fast and compact ZU40 range has feature such as payloads of up to 2kg and velocity of 700 mm/s with repeatability 0.01 mm.

## Key Features

- Designed for high precision, high load, continuous operation with highly accurate positional repeatability.
- 100% duty cycle.
- Multi-turn absolute encoders & endless rotation.
- Fully independent vertical and rotational motion.
- Hollow shaft maximises functionality of tooling attachment.
- Available with standard and HG60 mounting adapters.
- Plug & Play via supplied Easy Teach Software. All units are supplied pre-tuned.
- Zero-maintenance bearings.



## Specification

### ZU40

#### MOUNT

SD – Standard  
HG – To fit GD-HG80

#### CABLE ENTRY

L – Left side  
R – Right side

- ZU40-SD-L: Standard mounting kit, left hand side (when viewed on front face) cable entry.
- ZU40-HG-R: Standard mounting kit, right hand side (when viewed on front face) cable entry.

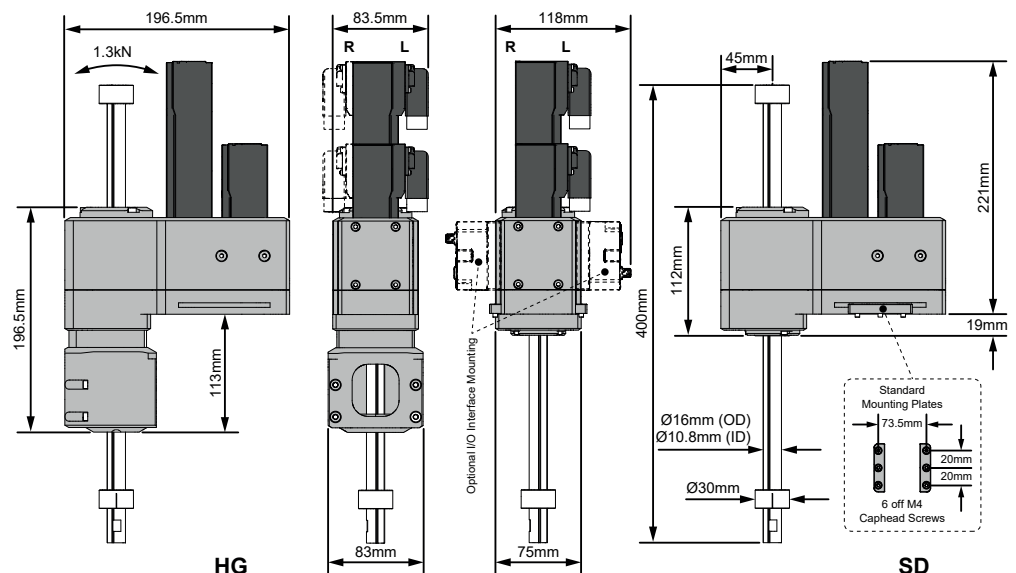

## Specification (continued)

DRIVE TYPE	Twin servo motor belt drive	MAXIMUM PAYLOAD (kg)	2.2
ENCODER TYPE	Multi-turn absolute encoder	MAXIMUM VERTICAL ACCELERATION (m/s <sup>2</sup> )	23.4
SHAFT TYPE	Hollow shaft	MAXIMUM VERTICAL SPEED (mm/s)	700
SPINDLE TYPE	Ball-screw spindle	MAXIMUM ROTATIONAL ACCELERATION (°/s <sup>2</sup> )	21000
Z-AXIS STROKE (mm)	150	MAXIMUM ROTATIONAL SPEED (°)	700
AXIS ROTATION	Endless	ROTATIONAL REPEATABILITY (°)	± 0.02
PERMANENT PRESSING FORCE (N)	93	MASS (kg)	4.7

## Mounting Options

The ZU can be supplied with a standard mounting kit for general purpose mounting, or with an adapter to suit mounting on a HG60 Planar Surface Gantry. Due to it's compact size, multiple ZU's can be mounted in close proximity, allowing for maximum flexibility.

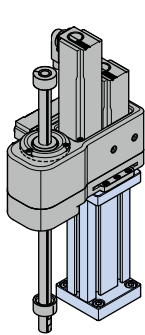

Standard Mounting Kit

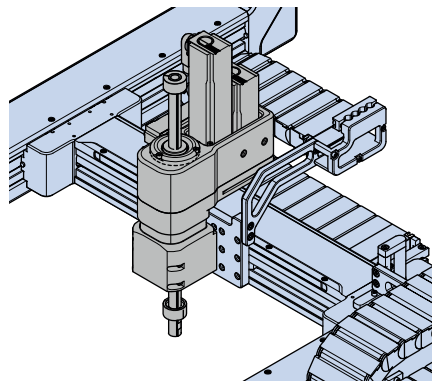

HG60 Mounting

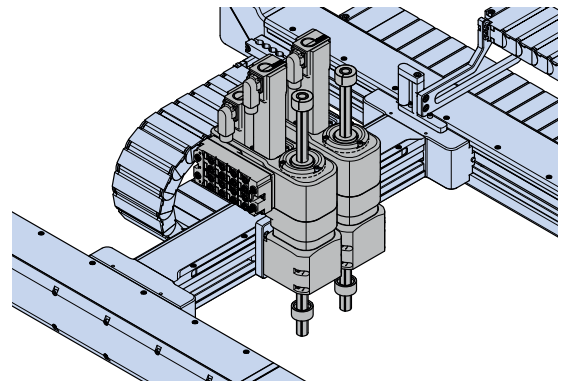

HG60 Twin Mounting with Optional I/O Interface

## Automation made easy

Designed with versatility in mind, Gorman Dynamics modular system and intuitive software solution enables seamless integration.

Without the need for intricate and time-consuming programming, our intention is to create a truly integrated platform for all of your automated needs.

Gorman Dynamics have made being better easier.



**Gorman  
Dynamics**

T. +44 (0)1202 118 444

E. [sales@gormandynamics.com](mailto:sales@gormandynamics.com)

[www.gormandynamics.com](http://www.gormandynamics.com)